

CIS User's Guide

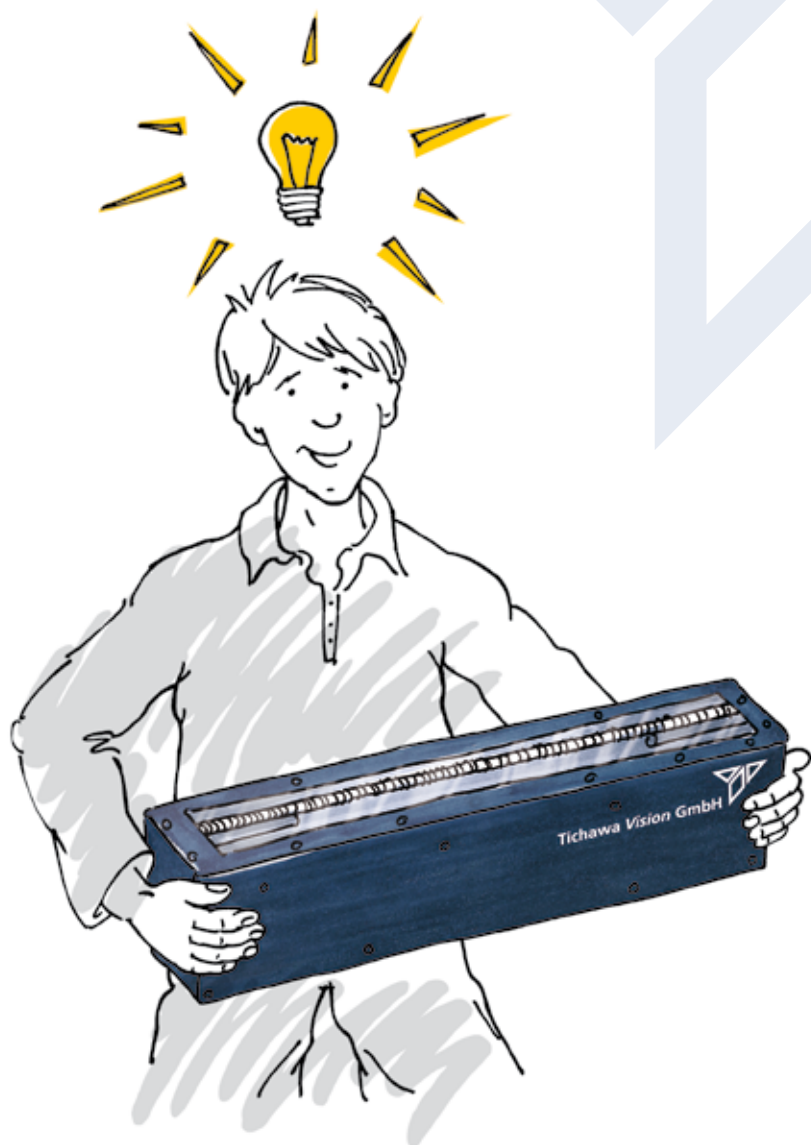

Tichawa *Vision* GmbH



	Page
Preparation	3
Unpacking & Handling	9
Mechanical Installation	14
Electrical Installation	17
CIS / Frame Grabber Connection and Setup	22
Operation	25
Maintenance	28
Illumination Safety	30
Returns	31

Impressum:

Tichawa Vision GmbH

Burgwallstraße 14 · 86316 Friedberg · Germany
 Phone: +49 (0) 821 455 553 0 · Fax: +49 (0) 821 455 553 20
 e-mail: info@tichawa.de · www.tichawa.com

© Illustrations: www.karin-bauer.com

Layout: www.morawetz-grafik.de

All rights reserved bei Tichawa Vision GmbH

Scan Width > Object Width + Margin

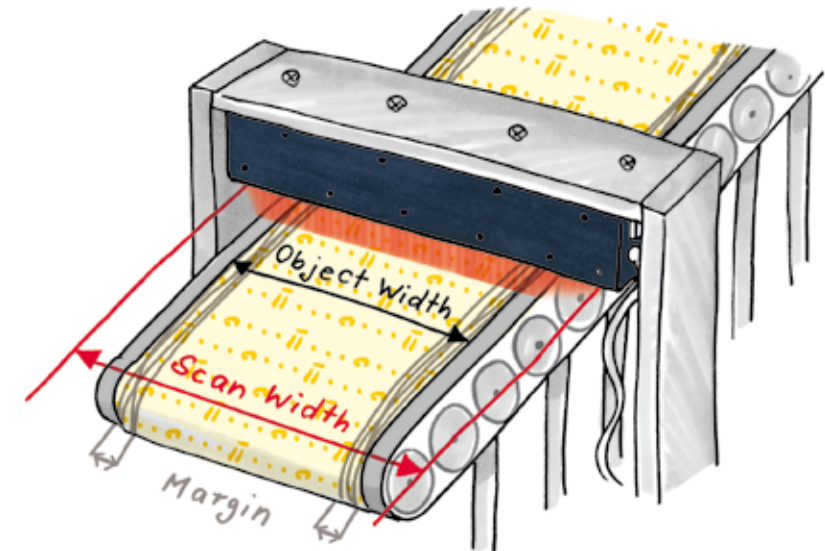

Resolution

Defect > 3 x 3 pixel

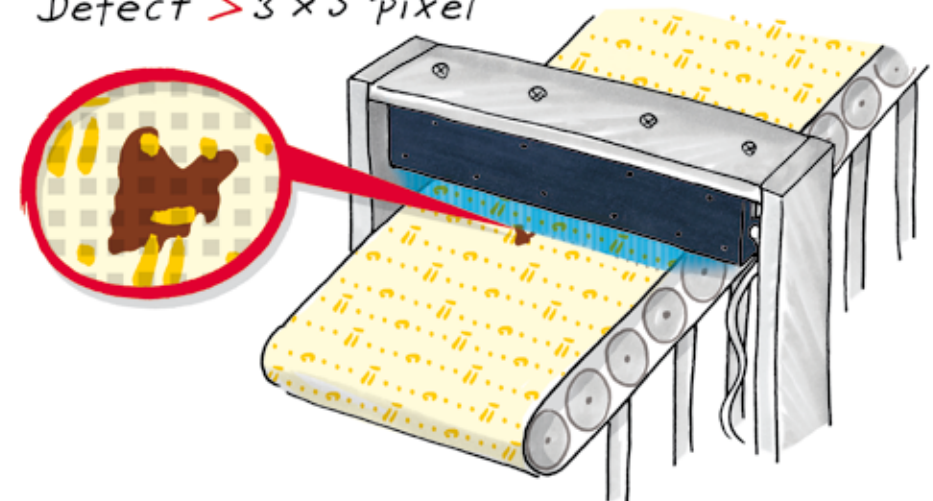

Transport Speed

<http://tichawa.com/downloads.html>
(Downloads – Software)

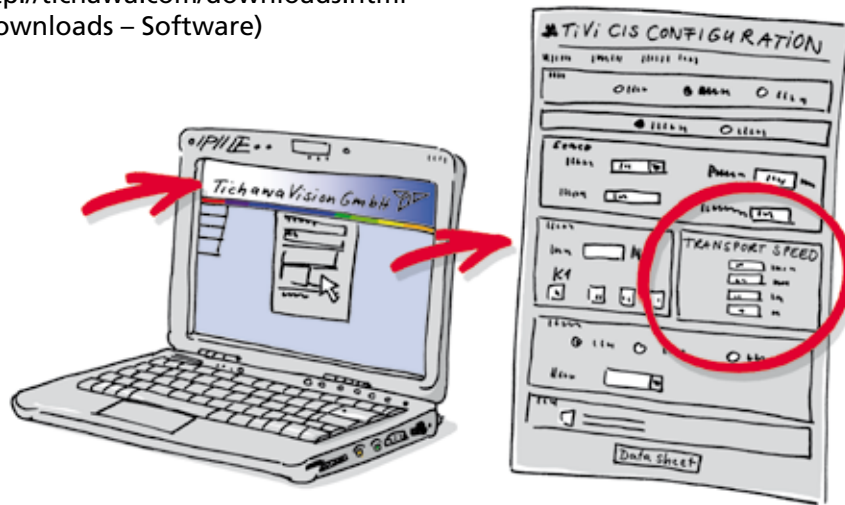

Proper Wiring

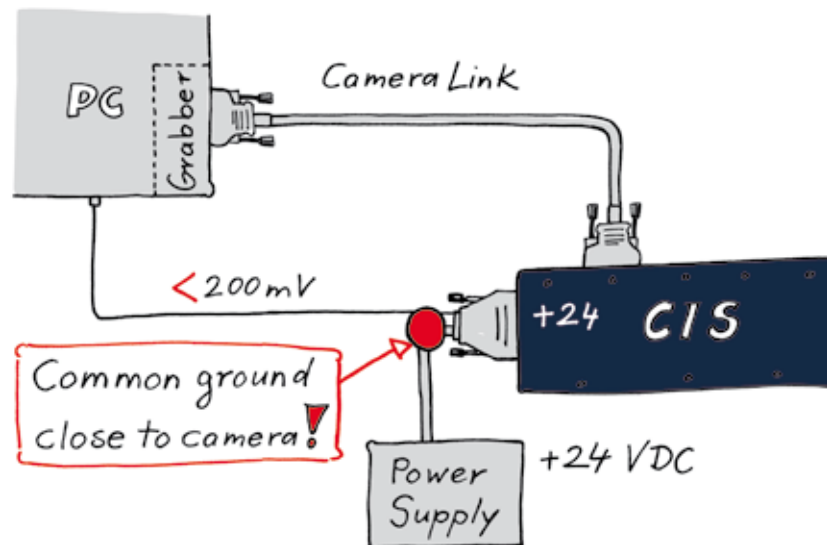

Illumination

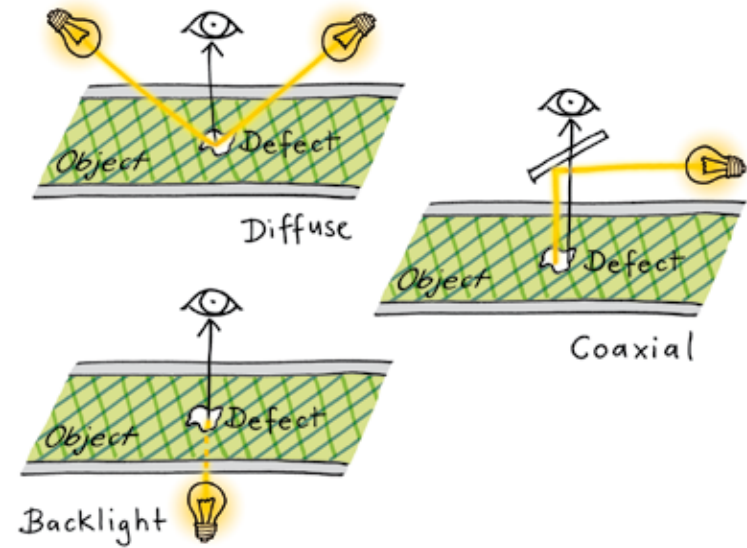

View Parametric Drawing

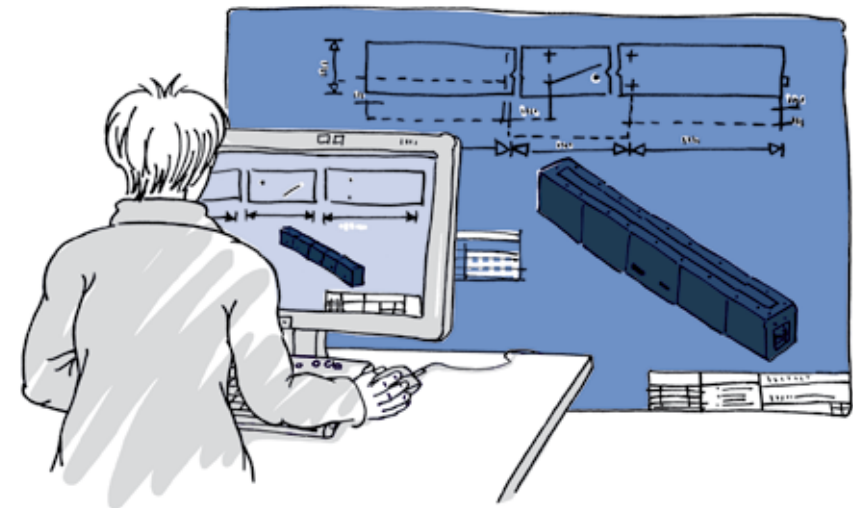

View STEP File



Integrate STEP File into your model



Case Temperature

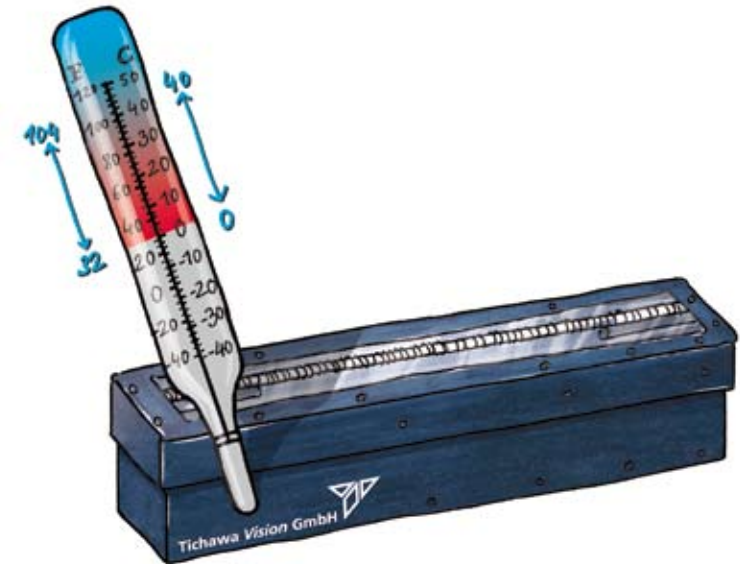

Humidity

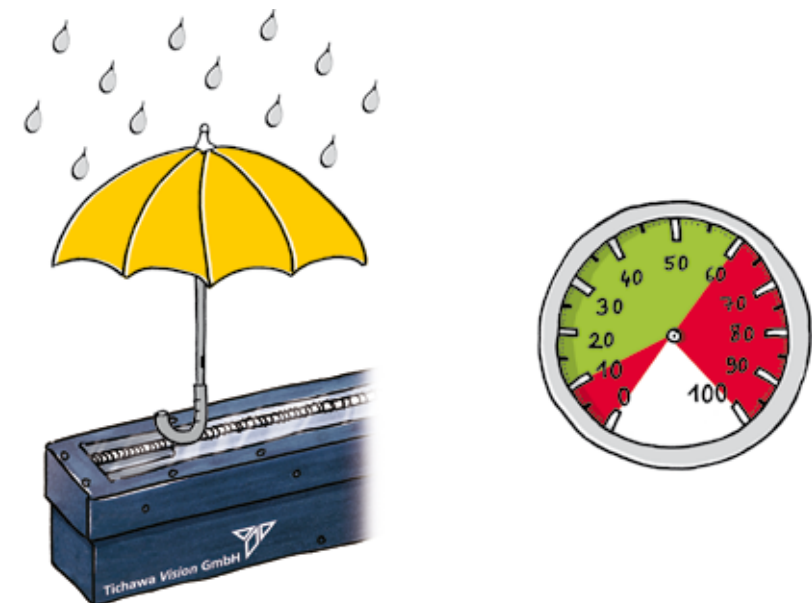

Shock & Vibration

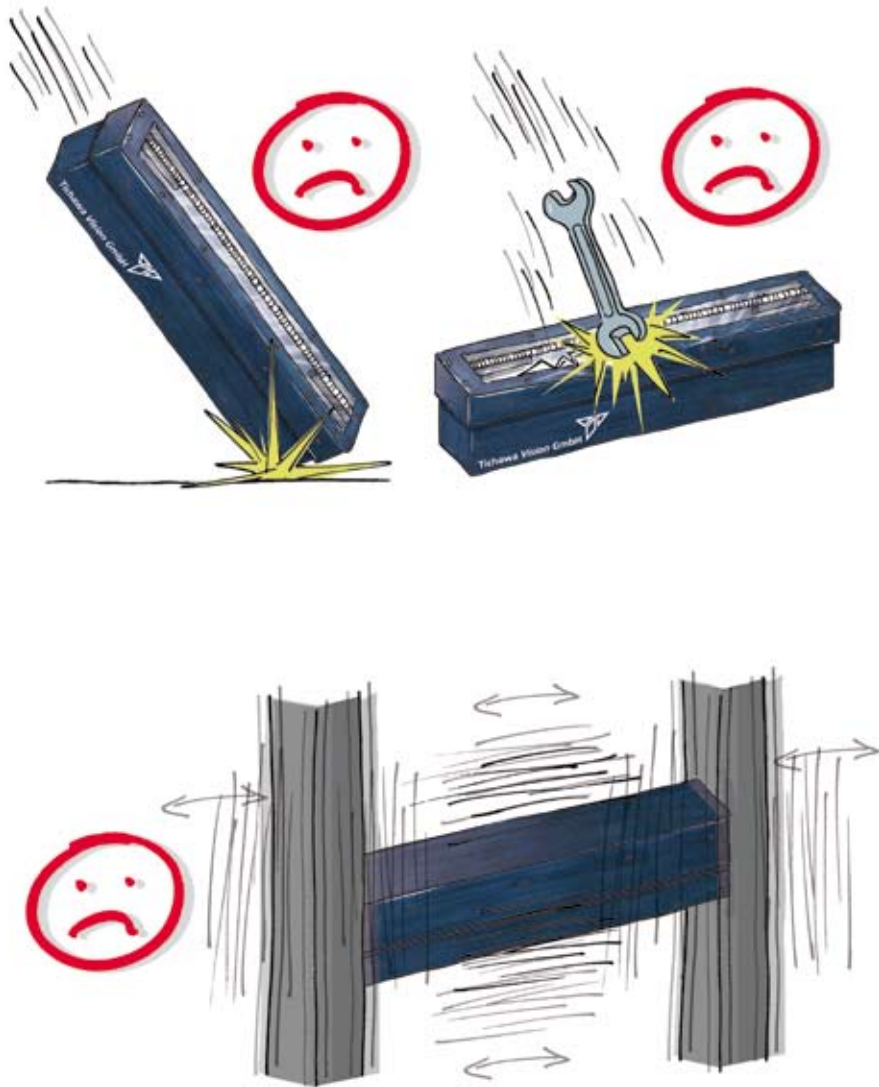

Check Shockwatches

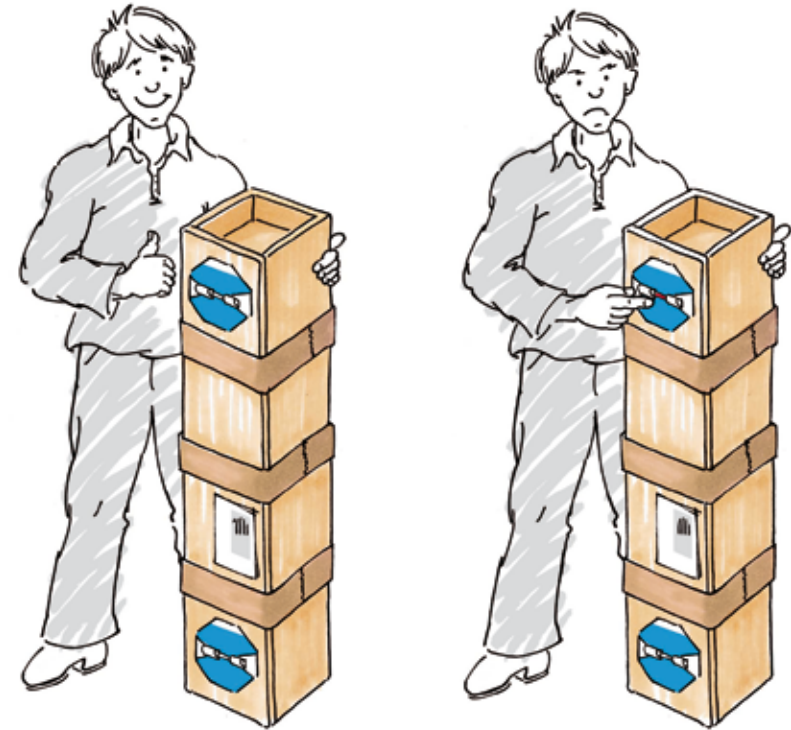

No long knives, scissors, axes or hammers

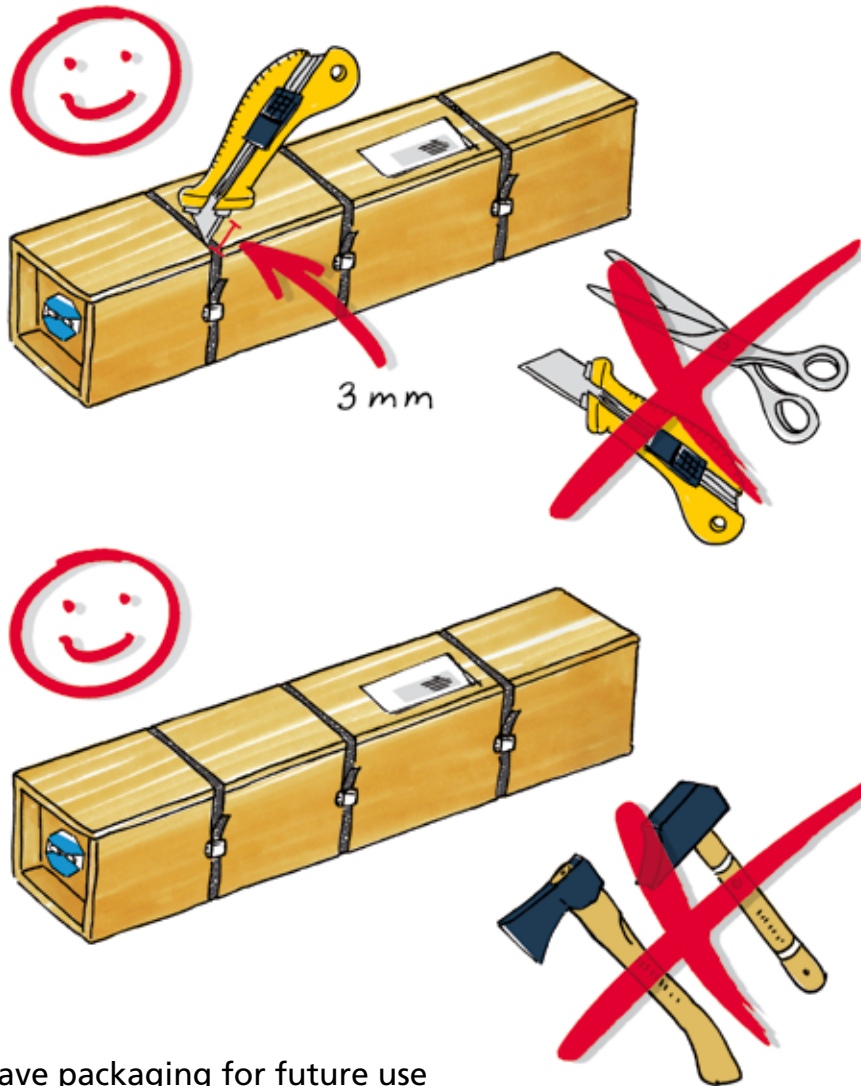

Save packaging for future use
if repairs are necessary

Protect Glass Surface

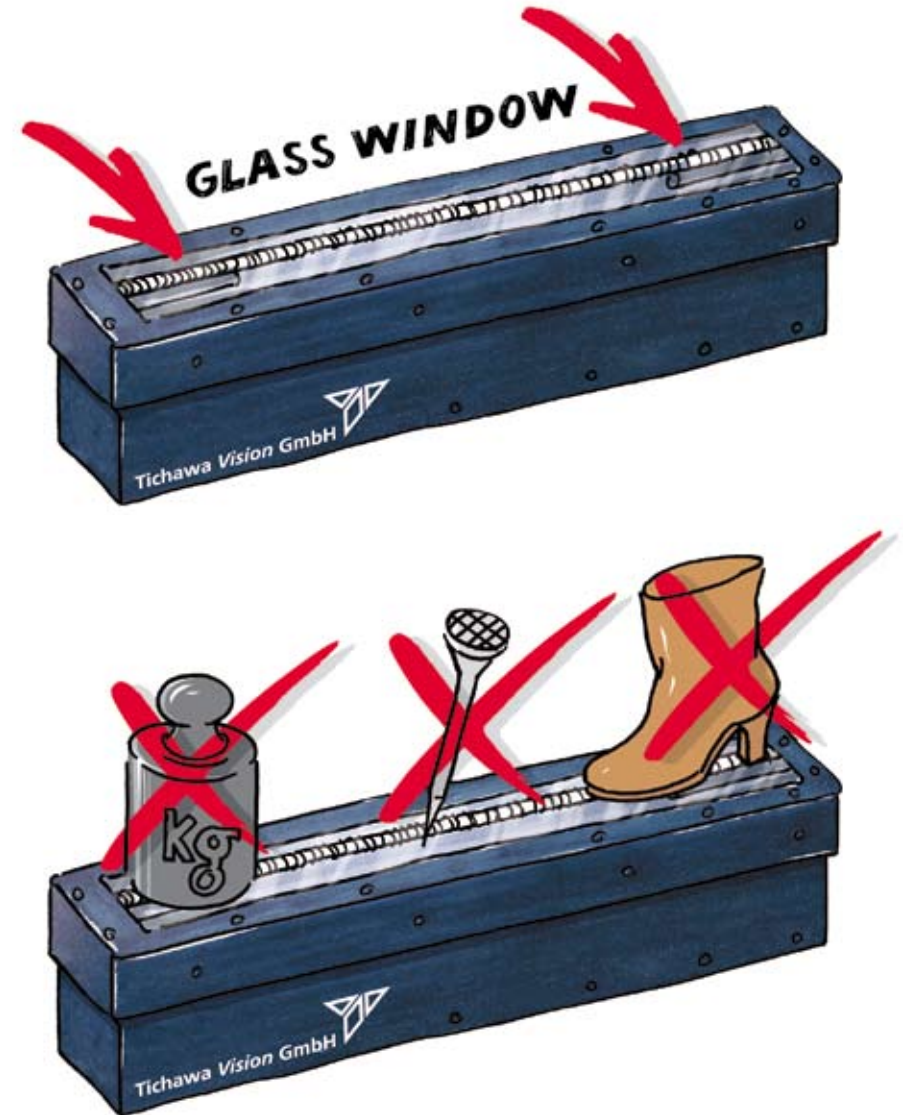

Check Camera Type Label



ESD Protection



Compare Product Label with shipping documents

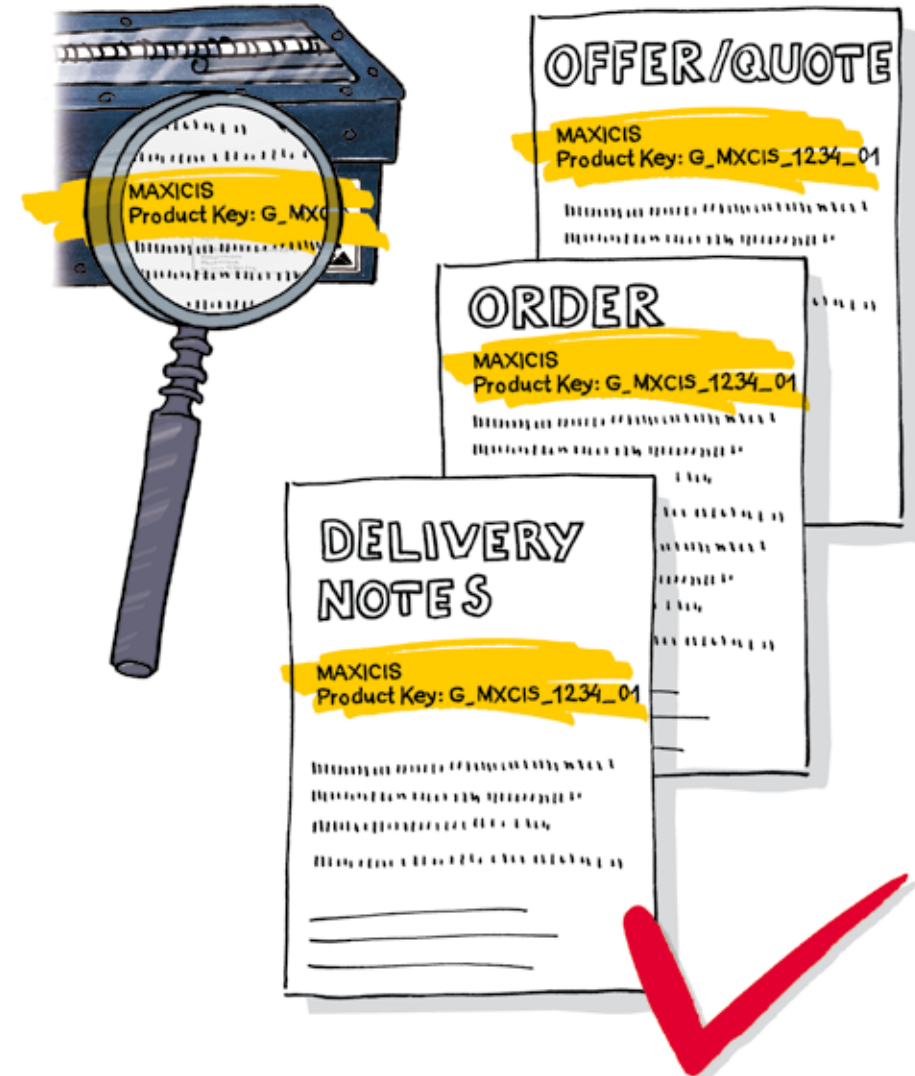

Use parametric drawing

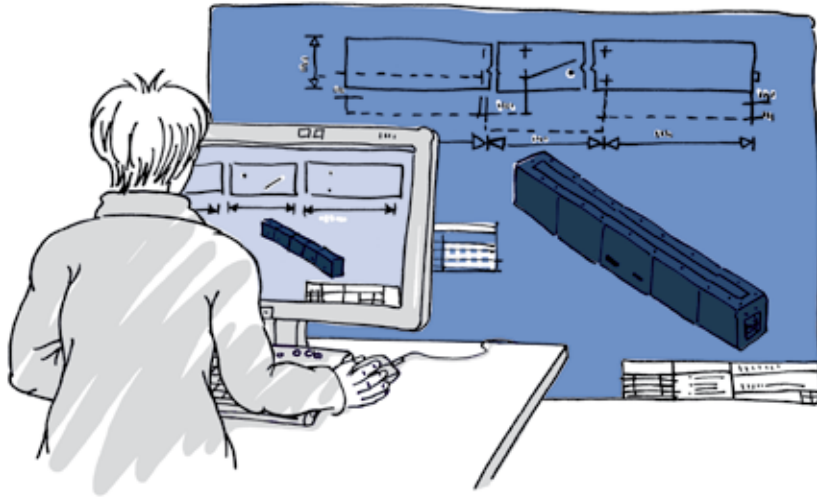

View STEP File



Use screws of proper length and thread

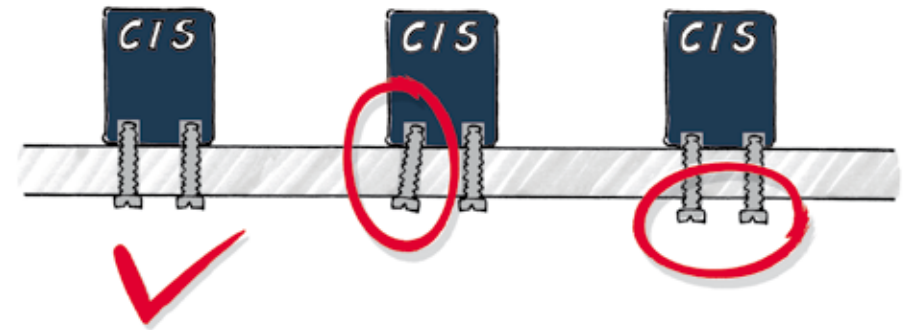

Mount on flat and even carrier only



Provide proper heatsinking

Chassis heat sink

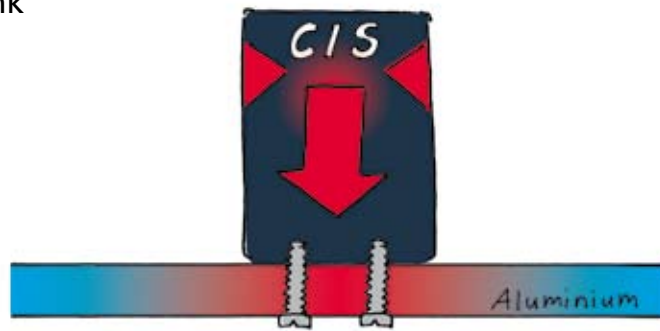

Air cooling

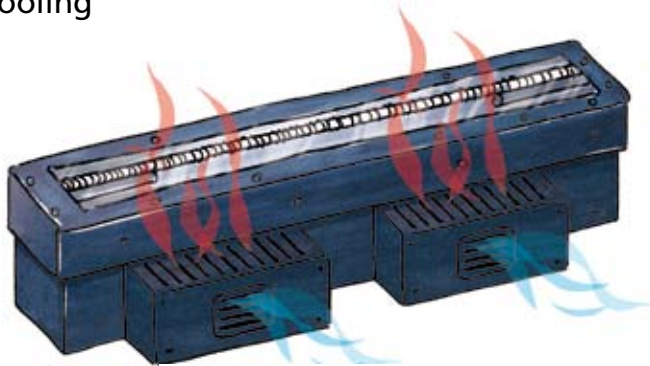

Liquid cooling

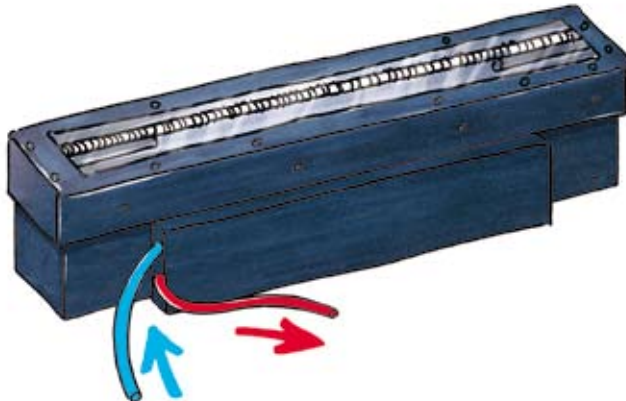

Check Camera Type Label



ESD Protection



ESD Protection

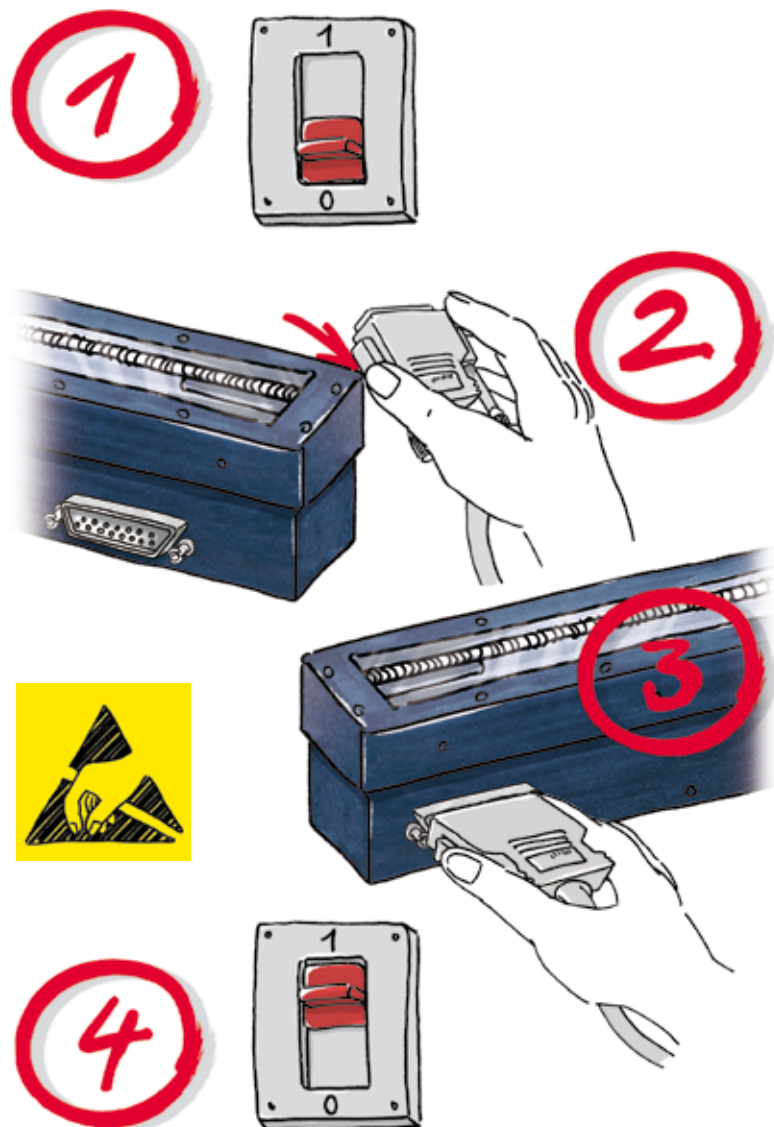

Camera Link Cable

Use connectors with screws, not with clamps

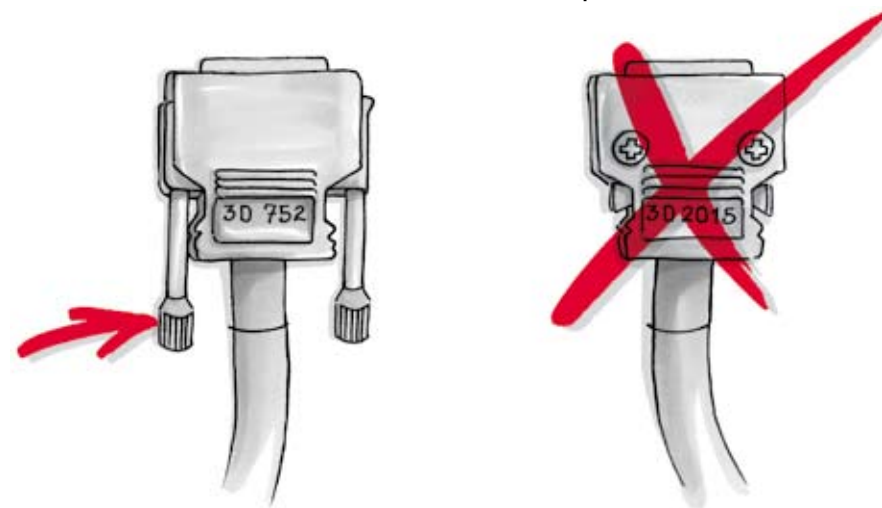

Camera Link Cables for Extended Length

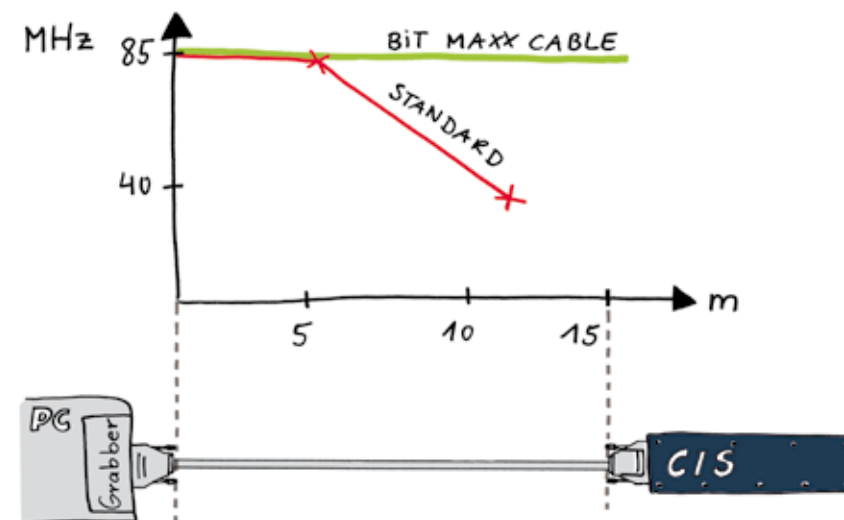

GigE Cable –
use connectors with screws

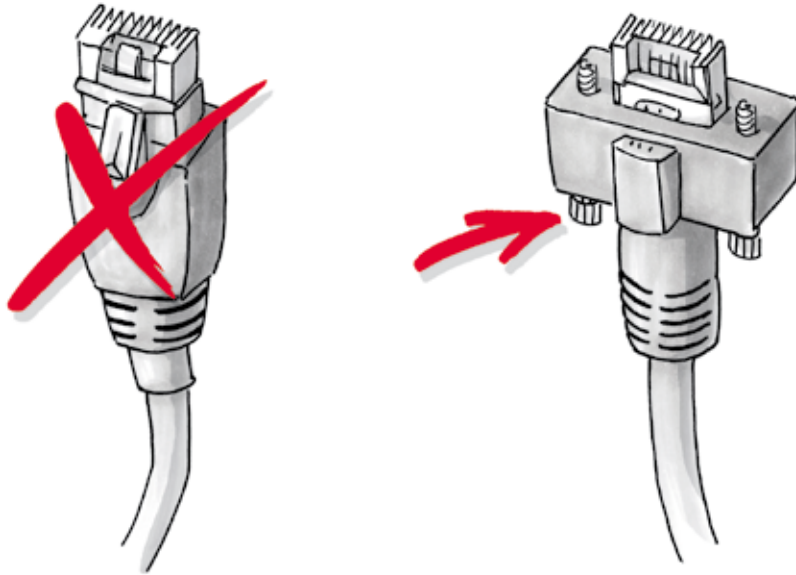

GigE Cable Length

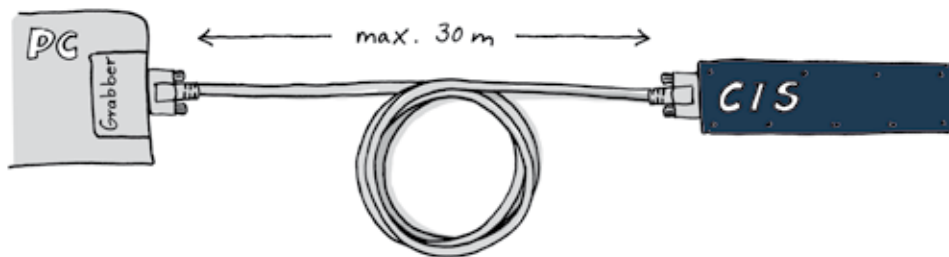

Triggering GigE Cameras

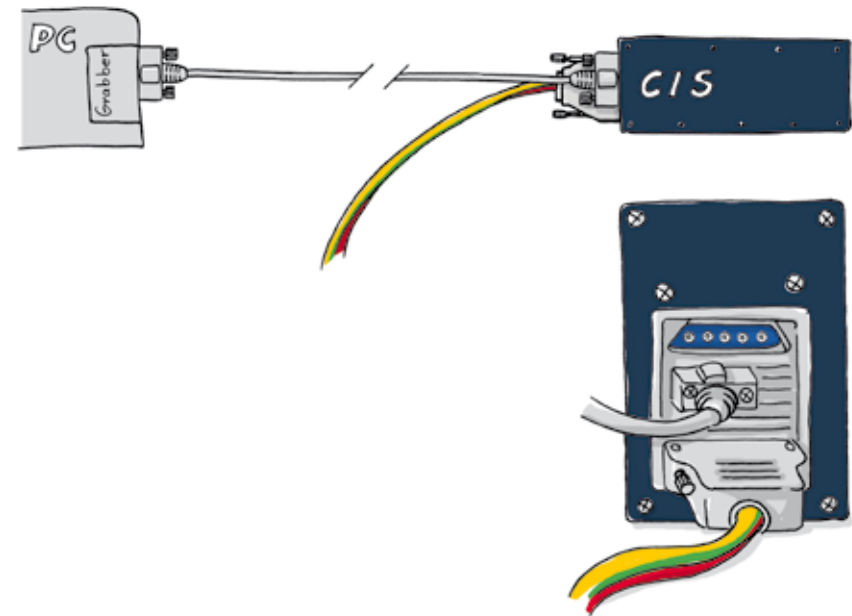

Be sure you are familiar with the CIS Operating Manual



Check Camera Link Standard

<http://tichawa.com/downloads.html>
(Downloads – Software)



Check Data Rate

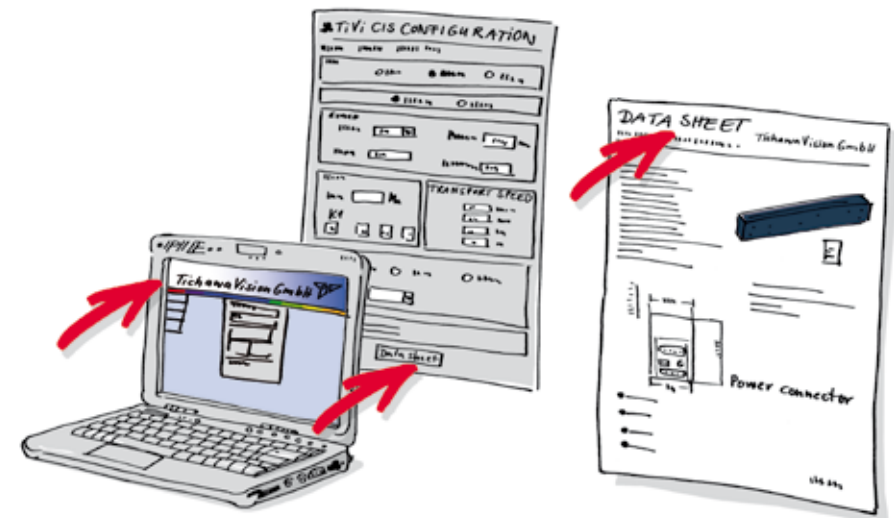

Check Serial Communication

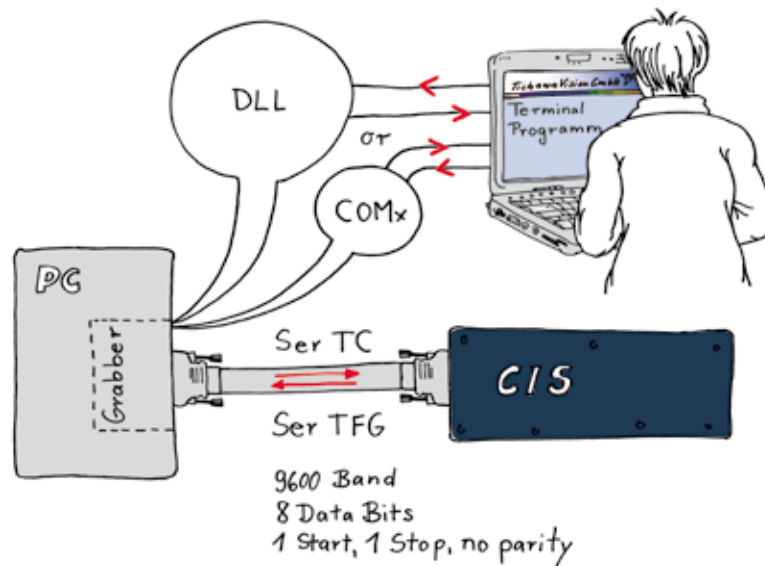

Use TiVi Terminal Program

<http://tichawa.com/downloads.html>
(Downloads - Software)

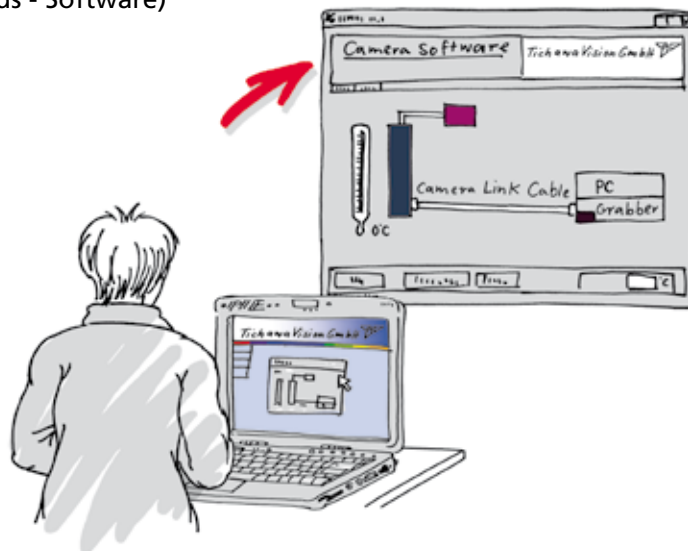

Keep free from dust and dirt



Clean window regularly with soft cloth

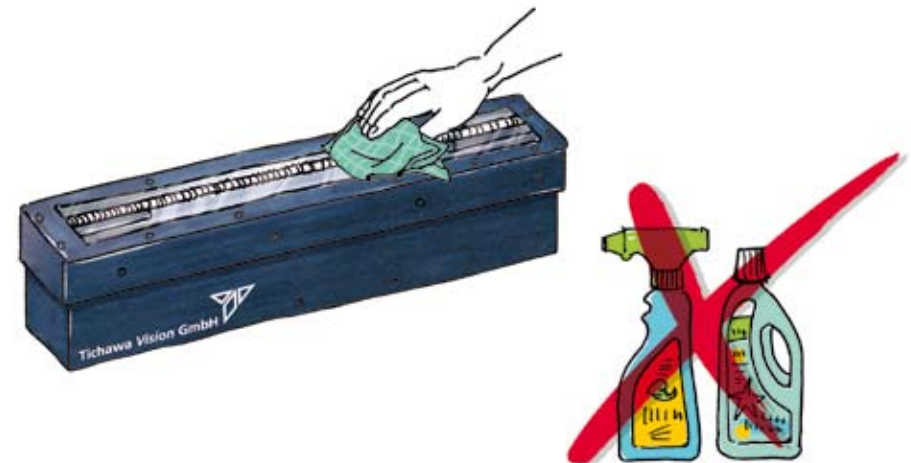

Prevent Cable Wear

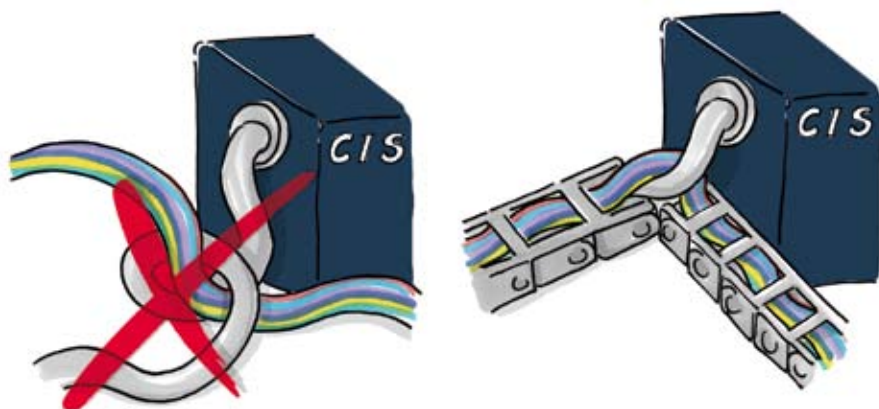

Keep case temperature low to increase lifetime

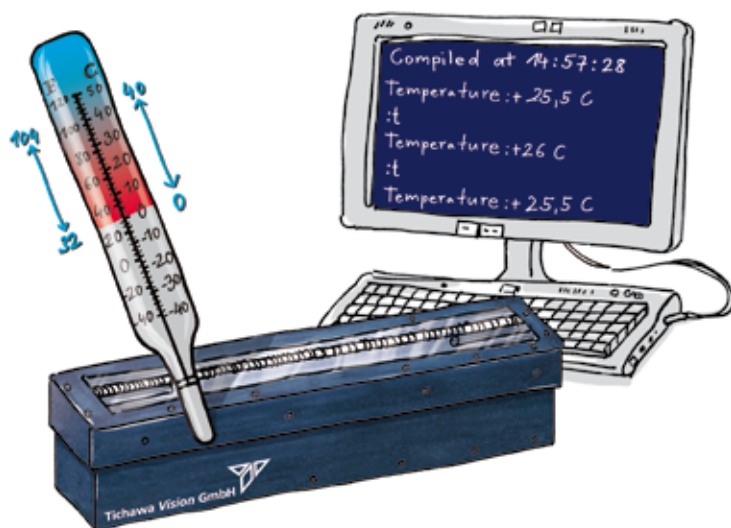

Protection

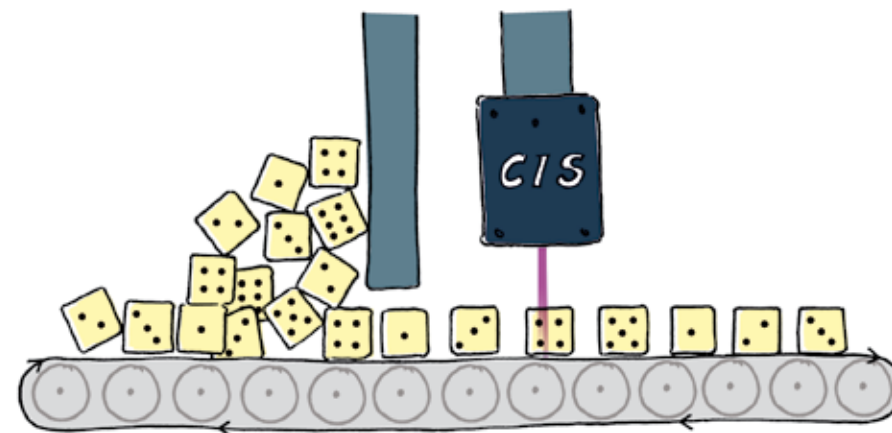

Alignment

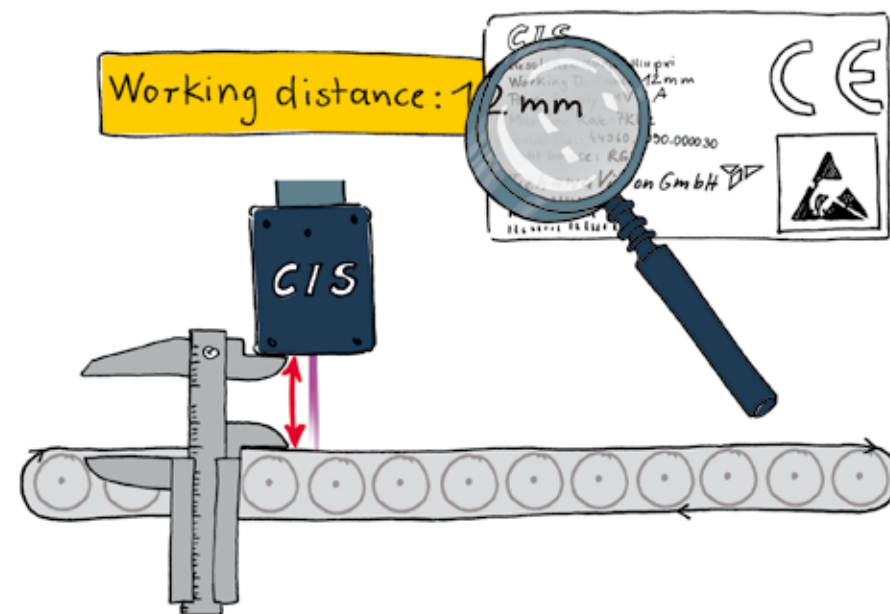

Be sure you are familiar with the CIS Operating Manual



Be sure you understand the shading calibration procedure

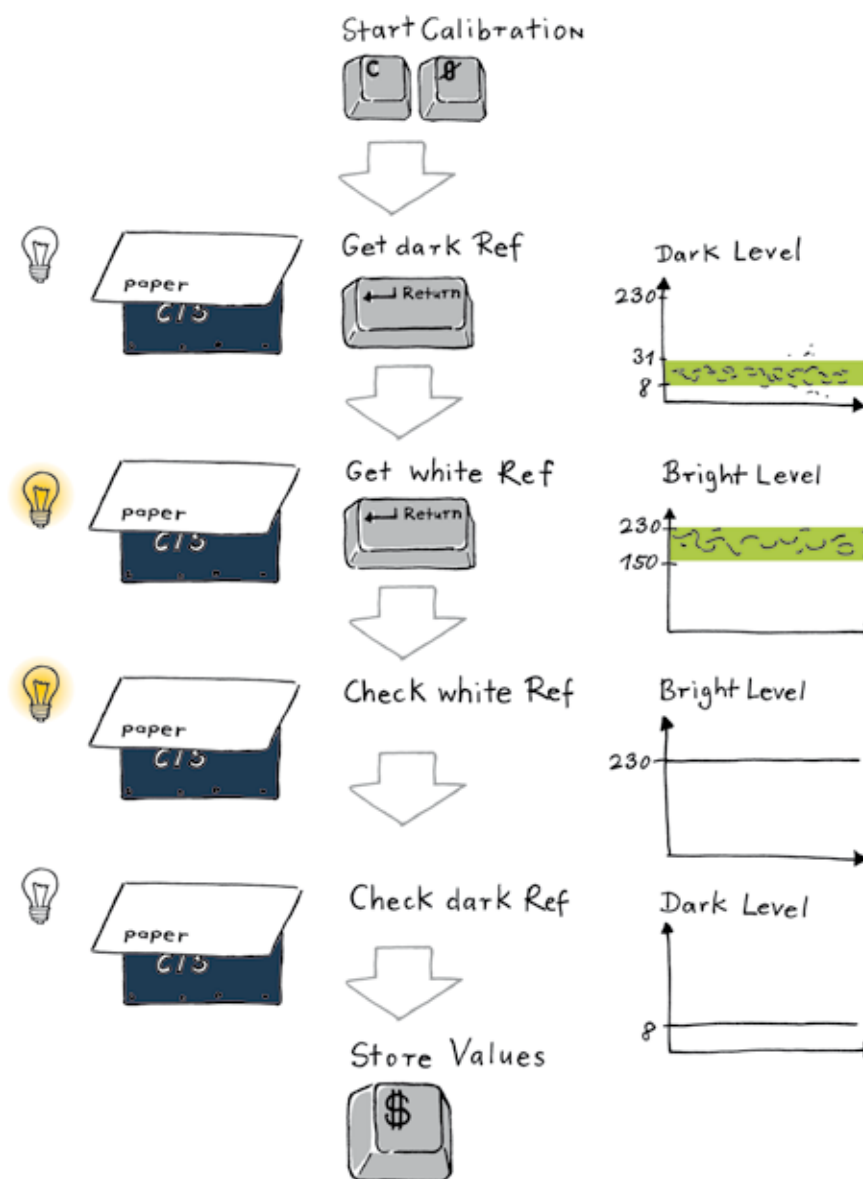

Do not look into the light source
Wear protective goggles

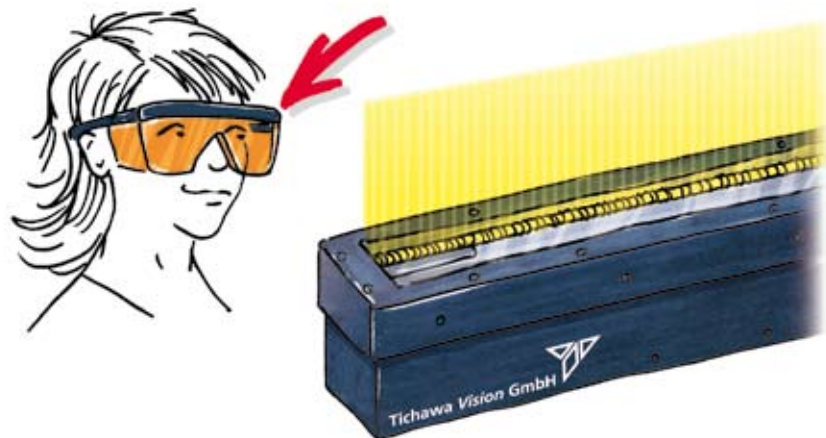

When working with the sensor,
do not wear rings, bracelets or wristwatches

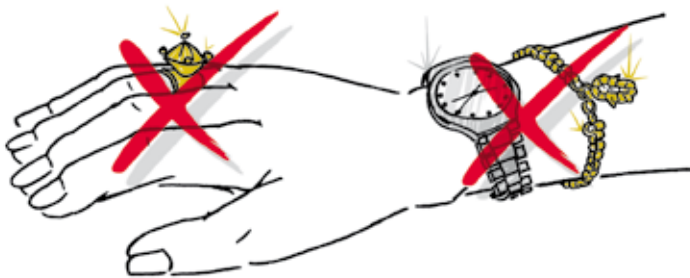

Keep to your national illumination
safety standards might apply

Use original package for shipping

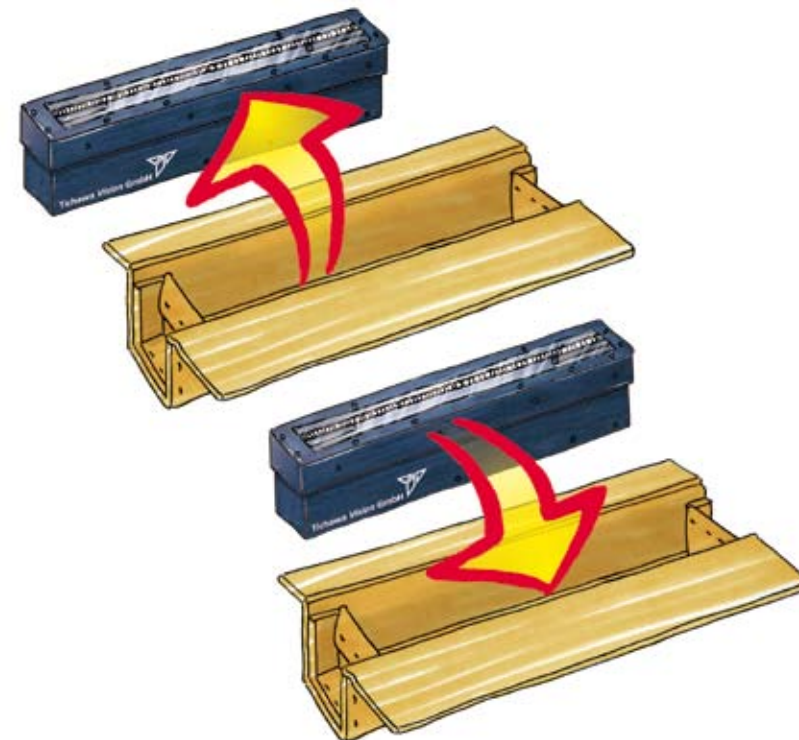

Mount Shockwatches, request new ones if already red

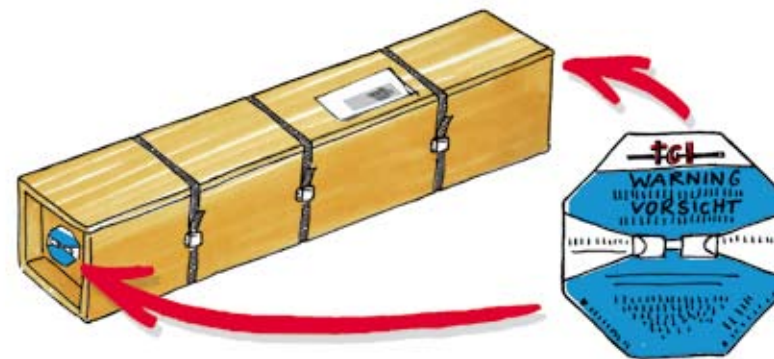

Contact Image Sensor – the much easier way!

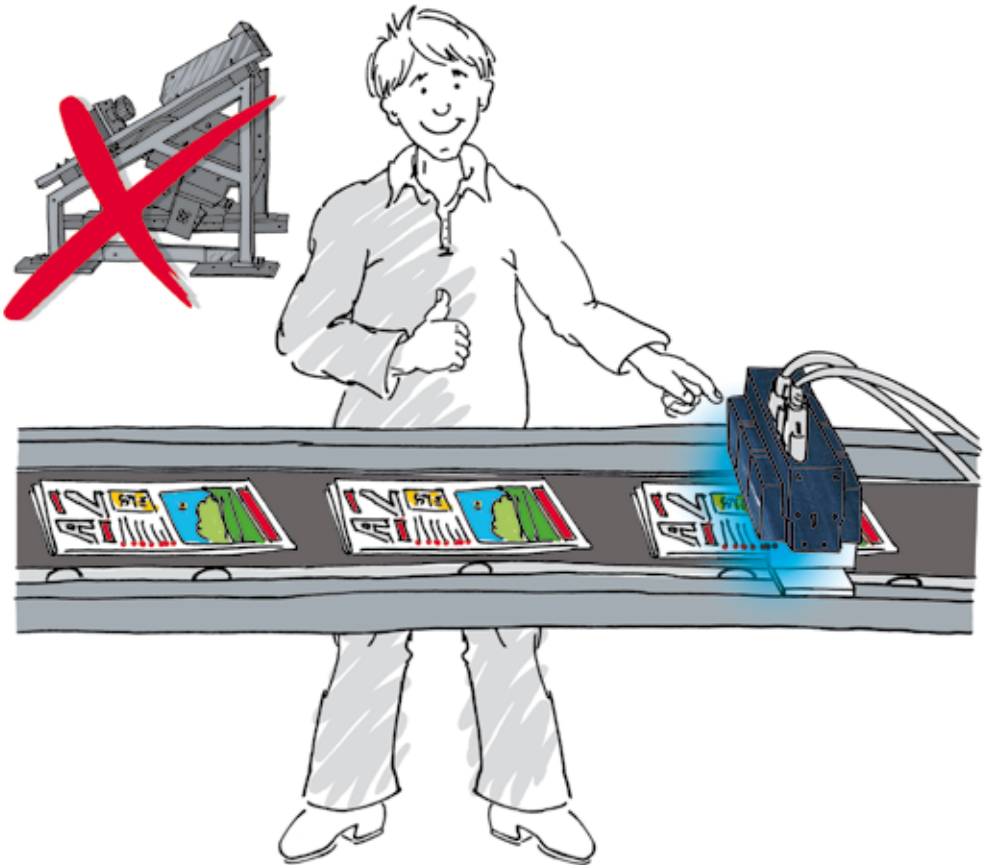

Tichawa **Vision** GmbH



Imaging technology for the future